



Tomintoul & Glenlivet  
Development Trust

## **CONSULTATION on Tomintoul and Glenlivet Development Trust: COMMUNITY DEVELOPMENT PLAN 2018-2022**

The purpose of this Community Development Plan is:

- To engage with the community to obtain a consensus for the development agenda and priorities for the period of the plan and beyond;
- To provide a focus, discussion agenda and consensus with development partners;
- To ensure ongoing funding for the Local Development Officer and other development staff;
- To plan for a sustainable future for the Trust to ensure that ongoing benefits of the current project portfolio of the Trust and the Tomintoul and Glenlivet Landscape Partnership (TGLP) are realised.

### **Achievements to date**

TGDT has overseen the development and delivery of several key projects including the renovation and reopening of the Smugglers Hostel, the development of a new 'Discovery Centre' due to open in 2018 and the running of a varied programme of events.

### **Portfolio of Projects**

The Trust has identified a portfolio of projects in consultation with the community, our partners and stakeholders, as follows:

#### **1. Mixed Development in Tomintoul and Glenlivet**

The main deliverables within the 2018-22 plan are as follows: *Affordable Housing; Holiday Park, with a mix of static/chalets, touring caravan facilities and camping; Visitor Attractions Feasibility Study* - the reception and visitor facilities at the Caravan Park would provide the infrastructure necessary for the addition of other visitor attractions over a longer planning period. Such facilities as a fishing loch, a clay pigeon shoot and a short course or pitch and putt golf development have been considered over the years; *Business Units; Enterprise Feasibility Study*

## 2. Development of further Adventure Activities

To work with Crown Estate Scotland on the enhancement of Adventure Activities such as the *Tomintoul Adventure Playground* and the *Bike Glenlivet Hub*. TGDT also aspires to possible developments and where feasibility studies may be considered within the 2018-22 plan including *Development of Lecht 2090* and *Equine Tourism*.

## 3. Working with the Dark Skies Project : Observatory and Science Centre

The following are the deliverables within the 2018-22 plan: *Building of a relocatable wooden observatory* and *Feasibility study for a permanent Observatory and Science Centre*

## 4. Development of Discovery Centre as Community Hub and Digital Archive

This project would involve the potential year-round operation of the Discovery Centre and building on its expanded role as a Community Hub, Visitor Information Centre and Digital Archive. The following are the deliverables within the 2018-22 plan: *Bourachs* – regular community gatherings to exchange ideas; *Volunteer and Membership Development and Engagement*; *University/College Outreach Centre*; *Portable Interpretation Devices*; *Digital Archive* – hosting for local interest and family history research.

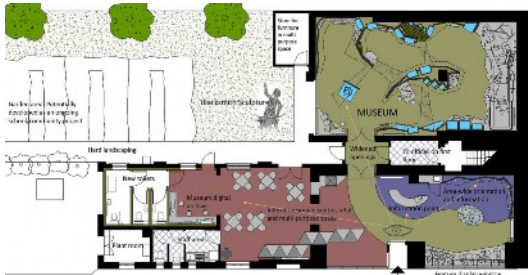

## 5. Marketing and Development of a Virtual Pathway to Discovery (building on the Landscape Partnership Project)



In the earlier stages of this plan, TGLP will be undertaking their plans for both Heritage and Wildlife. The Trust requires to be in a position to fully develop the legacy of this important

project. The project will examine how to use modern media as a means to link visitors and locals to the wildlife and heritage attractions through making the Discovery Centre a virtual pathway to real discovery. In close partnership working with the Landscape Partnership, the following is proposed: *Geo-tours and geo-*



*caching; Portable Interpretation Devices for wildlife and heritage sites; Marketing Plan* – including development of a visitor map, guide and other marketing materials. Provision of improved Tourist Signage to the Discovery Centre and main attractions.

## **6. Tomintoul & Glenlivet Participation Project**

This will involve promoting and coordinating consultation responses, promoting the volunteer opportunities associated with TGDT, T in the park, TGLP etc. and reviewing TGDT membership.

## **7. Development of Community Woodland and Walking Infrastructure**

The following are the deliverables within the 2018-22 plan: *Feasibility Study for Community Woodland* - the Trust will work with CES to identify areas of community woodland that TGDT could manage and develop for community benefit. Developments that would be distinctive visitor attractions such as: *Sculpture Trail, Woodland Garden, Junior Discovery Trail, Natural Burial Ground, Woodcraft Skills, Hazel/willow woodland for multi-purpose wildlife cropping (e.g. charcoal, fencing, hedging)*. Also to deliver a *Feasibility Study for a Walking Infrastructure Plan* – partnership working with the Trust may permit access to funds for the further improvement of the walking infrastructure in our development area.

## **8. Protection of the Community Benefits of Inveravon School**

The trust is disappointed about the closure of Inveravon School and its mothballing for 2 years. In the event that the school does not re-open, the trust has expressed its interest in the building and

its future benefit for the community. Depending on the outcomes within the 2-year mothballing, a feasibility study may be considered within the 2018-22 plan. The trust would seek to progress an asset transfer for the building with the idea of its possible use as the following: *a visitor centre with café and shop, possibly with a Pictish and archaeological theme and as a northern gateway to Tomintoul and Glenlivet; a hostel to provide accommodation for those walking the Speyside Way and other visitors; a community sports and meeting facility; and an educational outreach centre.*

## **8. Development of Sustainable Income for the Trust (Trading Subsidiary)**

The Trust aims at self-sustainability for its core activities during the period of this plan by further development of the Trading Subsidiary or the creation of other trading bodies. The existing business of the trading subsidiary is the Smugglers Hostel, the Discovery Centre and Events. The main additional activities that will contribute to the trading subsidiary during the period of the plan is the Mixed Development in Tomintoul and Glenlivet.

The following are areas in which TGDT aspires to possible developments and where feasibility studies may be considered within the 2018-22 plan: *Commercial Forestry; Renewable Energy;*

*Community Broadband* – With the demise of Cairngorms Community Broadband, the Trust will devise an alternative plan on behalf of the wider community. This would probably mean the establishment of a separate company. Depending on the financial model adopted, capital costs may be able to be returned and ongoing revenues generated

*Tomintoul and Glenlivet Business Centre* – this is presently occupied by the Landscape Partnership team, but following completion of this project it is planned that this will be offered as shared business space/business incubator. Rental revenues would contribute to the Trust.

***Please hand in or send the attached feedback Form to: TGDT, Crown Estate Office, Tomintoul, AB37 9EX or email [info@tgdt.org.uk](mailto:info@tgdt.org.uk)***